

## Green Star – Office Interiors v1.1

### Indoor Environment Quality IEQ-15 Indoor Plants

Points Available	Points Claimed	CIR Submitted
2	2	N

#### Credit Criteria

Up to two points are awarded, as follows:

1 point is awarded where it is demonstrated that indoor plants are incorporated in the tenancy fitout and comply with the following requirements:

- The plant species are selected on the basis of their suitability to indoor environments;
- A 'Horticultural Maintenance Plan' is in place (minimum two years) to ensure that the health of the plants is maintained; and
- There is a minimum density of one large plant (300mm pot) or two small plants (200mm pot) per two work settings, distributed over the NLA.

2 points are awarded where the above is demonstrated, but the plant density is increased to a minimum of one large plant or two small plants per work setting.

#### Documents Provided

✓	<p>Information from the plant supplier that confirms the quantity and species of all plants supplied.</p> <p>AND</p> <p>A statement from the plant supplier that the plants were selected for their suitability to indoor environments;</p> <p>AND</p> <p>Information from the sub-contractor that confirms that the plants supplied were installed within the tenancy fitout. <b>IEQ-15: 1</b></p>
✓	<p>A copy of the Horticultural Maintenance Plan that includes:</p> <ul style="list-style-type: none"> <li>- the location and density of plants</li> <li>- service intervals</li> <li>- soil moisture, pH and nutrient monitoring</li> <li>- watering and cleaning requirements</li> <li>- identification of plant disease or ill health</li> <li>- plant replacement regime (any plant of ill health must be replaced to ensure that the density of plants is maintained over the life of the Horticultural Maintenance plan) <b>IEQ-15: 2</b></li> </ul>
✓	<p>An extract from the maintenance contract that demonstrates at least a two year commitment to the Horticultural Maintenance Plan; <b>IEQ-15: 3</b></p>
✓	<p>A summary document that includes the total number and sizes of plants installed and the fraction of the NLA covered by the plants. <b>IEQ-15: 4</b></p>
✓	<p>A copy of the as-built tenancy plan indicating the location of the plants/planters. <b>IEQ-15: 5</b></p>

## Green Star – Office Interiors v1.1

---

### Discussion

- Sizes of plants and compliance described on page 51, IEQ-15: 4. Location of all plants called out on as-built plan supplied on page 52, IEQ-15: 5.

Rentokil Initial Pty Ltd ABN 98 000 034 597  
554 Somerville Road  
Sunshine Vic 3020  
T: (03) 9312 1500  
F: (03) 9312 1600  
M: 0416 193 794  
E: rokeefe@rentokilinitial.com.au

14 March 2008

Joe Karten  
Green Building Council of Australia  
L15, 179 Elizabeth Street  
Sydney NSW 2000

Dear Joe,

The following plant species have been supplied and installed to your office on Level 15 at 179 Elizabeth Street in Sydney as per BVN plan:

Plant Species	Number of plants provided	Plant size	Area of plants (m2)
Crassula ovata	16	200mm	3.2
Euphorbia	16	200mm	3.2
Sansevieria	16	200mm	3.2
Sansevieria	60	200mm	12
Cissus	17	200mm	3.4
<b>TOTAL</b>	<b>125</b>		<b>25</b>

The plants detailed above were selected for their suitability to indoor environments. The plants have been specifically grown for interior use and were considered ideal for this type of office environment.

Hire and maintenance service is undertaken on a regular basis (approximately every 11 working days) and will include hand watering, monitoring soil moisture and pH nutrient levels, fertilisation, dusting and cleaning of leaves, weed litter and dead foliage removal, replacement of unhealthy/ or unsightly indoor plants, replenishment of top dressing, insect and disease treatment and the pruning of foliage. This will ensure that each display is kept at the highest possible standard at all times. This horticultural maintenance plan will be in place for a minimum period of 24 months (2 years) to ensure the on-going health of the plants. Please find attached detailed documentation of servicing and maintenance





# Rentokil

## Tropical Plants

Rentokil Initial Pty Ltd ABN 98 000 034 597  
554 Somerville Road  
Sunshine Vic 3020  
T: (03) 9312 1500  
F: (03) 9312 1600  
M: 0416 193 794  
E: [rokeefe@rentokilinitial.com.au](mailto:rokeefe@rentokilinitial.com.au)

undertaking. Any plant of ill health identified during maintenance service will be replaced to ensure that the density of plants is maintained over the life of the service contract. Rentokil Tropical Plants will provide maintenance to the plants in your office over the next 2 years as per contract.

If you have any further questions, feel free to contact me at 0416 193 794.

Kind regards,

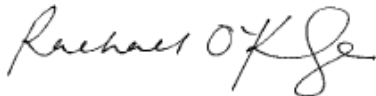

Rachael O'Keefe  
National Design Manager  
Rentokil Tropical Plants

LEADING EDGE  
PLANT HIRE SPECIALISTS



\*At the request of Ambius Indoor Plants, the Service Manual provided as part of the submission has been removed due to the intellectual property it contains.

The following documents were provided in order to comply with IEQ-15 Additional Guidance:

- Cleaning of Plants
- Pest Control
- Watering
- Fertilising
- Pruning and Trimming



# Rentokil

## Tropical Plants

## Service Agreement

Agreement No: 09488

## Client Details (the "Client")

Name/Company Name	The Green Building
ABN	Council
Trading As	"Greenhouse Site"
No & Street	Level 15 179 Elizabeth St
Suburb & Post Code	Sydney 2000
Business Phone	02 8252 8222 Fax 02 8252 8223
Business E-mail	joe.karten@gbcavv.org

Branch Office Address	Rentokil Tropical Plants 554 Somerville Road 2 Brennan St Alexandria 9312 1500 9312 1500
Phone:	02 9395 0571 Fax: 02 9310 3607

It is hereby agreed that:

- The company will install where applicable and maintain the Displays as itemised in the Display Schedule below in accordance with the terms and conditions of this agreement.

Clients Installation Address				
Display Type	No of Displays	Rate/Week	TOTAL PER WEEK	
Rental and Maintenance:				
- Rental Plus/Executive	plants supplied as per installation letter			
- Classic Range				
- Traditional Range				
Maintenance Only				
Australiana				
Silk Options				
Christmas Plus				
		Total Weekly Rental		
		GST		
		Net Weekly Rental		

- The client agrees to accept the Company's Displays and Service for an initial minimum term of twenty-four (24) months commencing from the Agreement date. At the expiry of the initial minimum term, the rights and obligations of the parties under this Agreement will automatically extend thereafter until this Agreement is determined by either party giving at least three (3) calendar month's written notice of its intention to terminate this Agreement provided that such notice shall not take effect until after the last day of the initial minimum term of 2 years.
- Rental is payable in advance each calendar month at \$ [REDACTED] per month.
- The installation fee is a once off fee of \$ [REDACTED] (Ex GST) and will be invoiced with the first monthly invoice.
- In addition to all rental charges and fees quoted above the client agrees to pay the gross goods and services tax applicable to this Agreement in accordance with clause 18 overleaf.
- This Agreement is also subject to the term and conditions overleaf.

ROMADEN	
Signed on Behalf of mentioned Client	
By executing this Agreement, the signatory warrants that the signatory is duly authorised to execute this Agreement on behalf of the Client.	
Name in Block Capitals	ROMILLY MADEN
Position	Chief Executive
Agreement Date:	15-1-08

Rentokil Initial Pty Ltd ABN 98 000 034 597	
Signed on behalf of the Company	
Rachael O'Keefe	
Name in Block Capitals	Rachael O'Keefe
Position	National Design Manager
Date:	15.1.08

## IEQ-15 Indoor Plants

A summary document that includes the total number of plants and sizes of plants installed as a fraction of the NLA covered by the plants.

	Number of plants provided	Plant size	Area of plants (m2)
	16	200mm	3.2
	13	200mm	3.2
	6	200mm	3.2
	60	200mm	12
	17	200mm	3.4
<b>TOTAL</b>	<b>125</b>		<b>25</b>

<b>Total area of plants:</b>	25m2
<b>Total NLA:</b>	804m2
<b>% of plants to NLA:</b>	= 25/804 x 100
	= 3.11% of NLA contains plants

Planter box plants

Green wall plants

As per the CIR ruling on the website that states:

**CIR Ruling:** The Credit Interpretation Request (CIR) to deem one plant (for one point) or two plants (for two points) per 30m2 NLA as equivalent of the current Criteria is **granted** provided that the plants are distributed across the NLA as per the Technical Manual:

- 1 point = one large or two small plant per 30m2 NLA; and
- 2 points = one large or two small plants per 15m2 NLA.

For Green Star – Office Interiors v1 and Green Star – Office Interiors v1.1, both approaches (the one in the Technical Manual and the one outlined above) are acceptable.

<b>Total NLA:</b>	804m2
<b>Total number of small plants:</b>	125 small plants
<b>Number of plants required (according to min. 2 small plants area of NLA:</b>	= 804m2/30m2 = 26.8 large plants required for 2 points <b>OR</b> = 53.6 small plants required for 2 points
Therefore, the GBCA fitout can claim the 2 points as there are 125 small plants, which exceeds the min. 53.6 plants required for 2 points.	



IEQ-15: 5

CASTLEREAGH STREET



BlighVollerNieldArchitecture

Telephone +81 3 0630 0100  
Facsimile +81 3 0630 0100  
www.bim.com.au

**INTELLECTUAL PROPERTY**

IS COPYRIGHT. EACH VOLUME HELD BY UPV-DRAWN, LALLOS OR OTHERWISE  
ACROSS IN WRITING. ALL RIGHTS TO USE THIS DOCUMENT ARE SUBJECT  
TO PAYMENT IN FULL OF ALL RELEVANT CHARGES. THIS DOCUMENT MAY ONLY  
BE USED FOR THE SPECIFIC PURPOSES AND PROJECT FOR WHICH IT WAS  
CREATED AND DESIGNED. AS NOTED IN WRITING BY UPV AND THIS  
DOCUMENT MAY NOT BE OTHERWISE USED, OR COPIED AND/OR TRANSMITTED  
IN ANY MANNER. ALL RIGHTS ARE RESERVED BY UPV AND THIS DOCUMENT  
MAY NOT BE USED IN ANY MANNER WITHOUT WRITING FROM UPV.

ISSUE	DATE	FOR
01	03.10.07	INFORMATION
02	03.10.07	INFORMATION
03	11.10.07	INFORMATION
04	17.10.07	APPROVAL
05	22.10.07	APPROVAL
06	22.10.07	CURTAIN RAILS DELETED

CONSULTANT  
DAVIS LANGDON  
tel 02 9958 8822 fax 02 9956 8648  
CONSULTANT  
LINCOLNE SCOTT  
tel 02 8907 0800 fax 02 9957 4127  
CLIENT

GBCA  
 L15, 179 ELIZABETH STREET  
 SYDNEY NSW 2000  
 CLIENT PROJECT 146.

PROJECT

GREEN BUILDING COUNCIL  
OF AUSTRALIA

M0709010

TRUE NORTH PROJECT NORTH

GRAPHIC SCALE

PERCENT

SCALE

0 2000 5000

1:100 of A2 DO NOT SCALE

STATUS

## CONCEPT DEVELOPMENT

## GENERAL ARRANGEMENT FLOOR PLAN

DRAWING NUMBER	REVISION
A-D-01	06

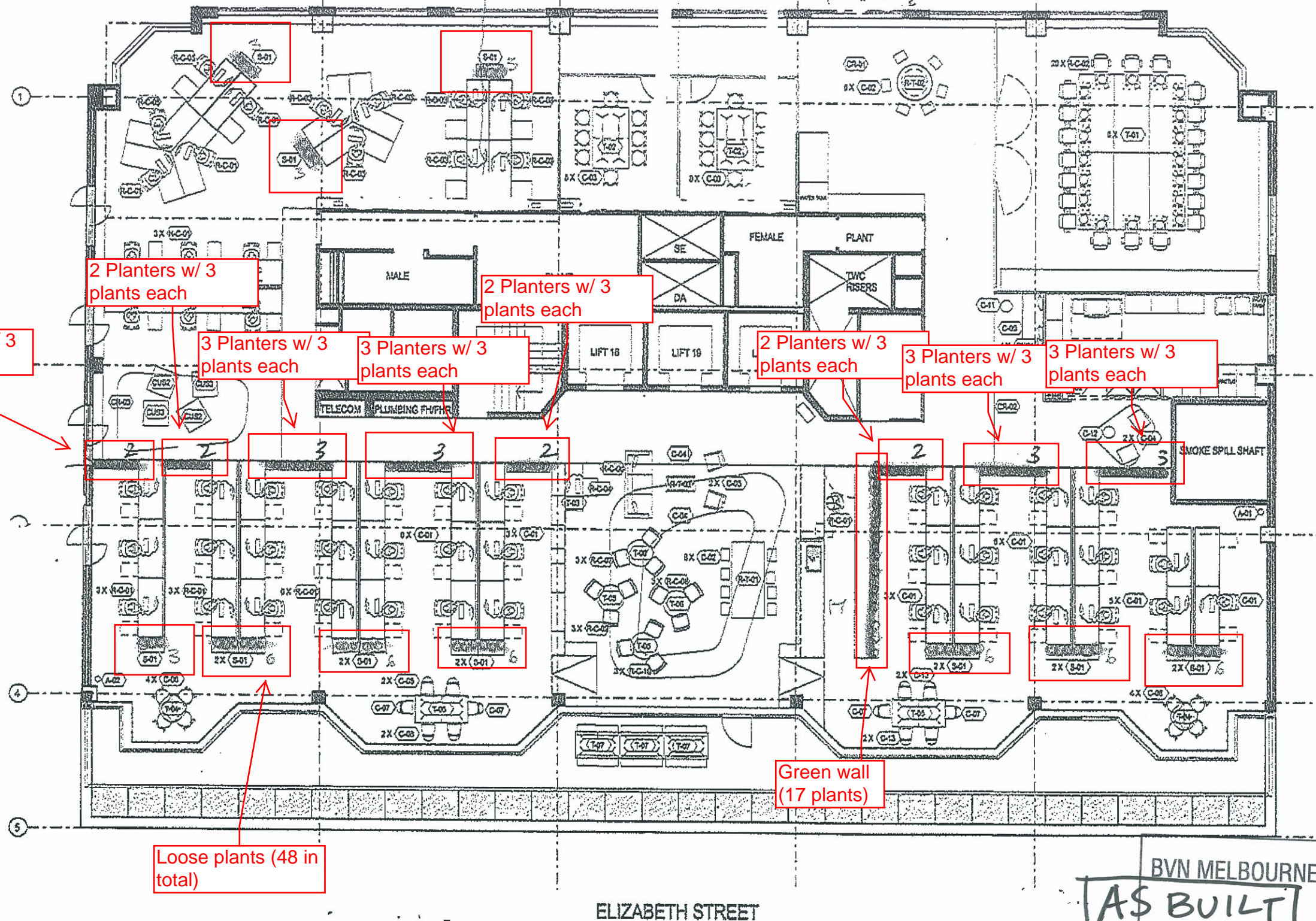

01 FLOOR PLAN

1:120

Floor Standing troughs - as marked  
 Desktop planters - 3 per cabinet - as marked  
 plants only (client owned liners) to climb up stainless steel wire

PROJECT:	UBCA
FILE:	

GENERAL ARRANGEMENT FLOOR PLAN	
DRAWING NUMBER	ISSUE
A-D-01	06

BVN MELBOURNE

AS BUILT

12 JUN 2000

1 ATTENTION:

PROJECT: **98CA**

FILE: